

Installation instructions:



AKRAPOVIC RACING & EVOLUTION EXHAUST SYSTEM for the KAWASAKI ZX 10 R (2004 - 2005)

Congratulations on purchasing an Akrapovic exhaust system. Please read these installation instructions carefully. If you have any trouble installing the system please contact your authorized dealer!

IMPORTANT INFORMATION

Exclusion of Certain Liability

1. The manufacturer, importer or dealer shall not be liable for any incidental damage including personal injury or any other damages caused by improper installation or operation of the Akrapovic exhaust system. When installing the Akrapovic exhaust system be careful that the exhaust system does not touch other parts sensitive to high temperature.
2. Akrapovic makes no representation or warranties with regard to damage caused by the improper installation, use and maintenance of the Akrapovic exhaust system. The warranty is limited to defects recognized by our technical department and to normal use, and excludes items subject to normal wear (gaskets and damping wool). The guarantee is void in case of accident, modification, improper or competition use.
3. Do not attempt to install the Akrapovic exhaust system on a motorcycle for which it was not made or tested by Akrapovic.
4. When the exhaust system gets very hot during operation, be careful not to burn yourself on the exhaust system or parts which are in direct contact with it, even when the motor is not running. Also protect other people, especially children, from the injuries mentioned above.
5. In some cases Akrapovic exhaust system kits contain chemical products (ceramic anti-seizing grease; bolt sealant). Handle with care, do not inhale or swallow. Avoid excessive contact with skin, eyes or mucous membranes. Keep out of reach of children.
6. Technical specifications of Akrapovic exhaust systems and related products subject to change without notice.

Trademarks

The Akrapovic Exhaust System Technology logo is a registered trademark of Akrapovic d.d.

Akrpovic website

Information about Akrapovic exhaust systems and related products is available on the Akrapovic website at:
<http://www.akrapovic-exhaust.com/>

Copyright

No part of the Akrapovic exhaust system or its documentation may be reproduced or distributed in any form or by any means without the prior written authorization of the Akrapovic company.





© Akrapovic d.d. All rights reserved.

Symbols

The following symbols are used throughout these installation instructions:

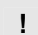

INSTALLATION INSTRUCTIONS

- | |
|--|
|  BEFORE INSTALLING CHECK SCHEMATIC OF THE EXHAUST SYSTEM! |
|  IF ANY ITEMS IN THE AKRAPOVIC EXHAUST SYSTEM PACKAGE ARE MISSING PLEASE CONTACT YOUR AUTHORIZED DEALER. KEEP THE SCHEMATIC FOR FUTURE REFERENCE. |
|  THESE INSTALLATION INSTRUCTIONS MUST BE READ CAREFULLY IN ORDER TO ENSURE PROPER INSTALLATION AND OPERATION OF THE AKRAPOVIC EXHAUST SYSTEM. |
|  THE EXHAUST SYSTEM CAN BE EXTREMELY HOT. ALLOW THE MOTORCYCLE TO COOL DOWN BEFORE BEGINNING INSTALLATION. |
|  WE ADVISE YOU TO LEAVE INSTALLATION TO A QUALIFIED SERVICEMAN. IMPROPER INSTALLATION MAY RESULT IN A SHORTER LIFETIME OF THE EXHAUST SYSTEM AND/OR DAMAGE TO THE MOTORCYCLE. |

REMOVAL OF STOCK EXHAUST SYSTEM

1. put the motorcycle on a side stand, we recommend a racing stand
2. unscrew the bolt for the metal clamp on the link pipe (at the link pipe – collector joint) (Figure 1)
3. unscrew and remove the bolt for the metal muffler bracket (Figure 2)
4. remove the link pipe together with the muffler (link pipe and muffler are joint together by bolts). We recommend spraying the joint with a multi-purpose spray lubricant (WD-40 or equivalent)
5. unlock and remove the passengers seat (Figure 3, 4)
6. remove the fastback's plastic cover between both seats (Figure 5)
7. remove the drivers seat (Figure 6)
8. remove the safety pin for the servo motor cables (Figure 7)
9. turn the main ignition switch to "on" (Figure 8)
10. turn the ignition key to the "on" position, servo motor turns clockwise; unhook the right cable from servo motor (Figure 9, 10)
11. turn the ignition key back to the "off" position, servo motor turns counter-clockwise; unhook the left cable from servo motor (Figure 11, 12)
12. pull out the cables from rear part of the motorcycle (Figure 13, 14)
13. remove the lower and the middle parts of the cowling (Figure 15, 16, 17)
14. unscrew and remove the bolts and metal bracket of the water cooler (Figure 18, 19, 21); also remove the metal inner sleeve of the rubber damper; make sure not to damage the cooling fins (Figure 20)
15. unscrew and remove the nuts from the flanges of the header tubes; make sure not to damage the cooling fins (Figure 22)
16. unscrew and remove the bolt from the collector hanging bracket (Figure 23)
17. remove the stock collector and the stock header tubes (Figure 24)
18. remove the metal inner sleeve of the rubber damper from the collector hanging bracket (Figure 25)

INSTALLATION OF THE AKRAPOVIC RACING OR EVOLUTION EXHAUST SYSTEM

installing the header tubes:

1. **CAUTION**
 - a) In case of the shorter length of the bolts for fitting the header tube flanges **the stock copper gaskets have to be removed from the exhaust ports** in order to set the inner sleeves further into the exhaust ports so that the nuts fit onto the bolt threads. The sealing of the exhaust gases is unchanged and is still optimum.
 - b) In case of adequate length of the bolts for fitting the header tube flanges, **the stock copper gaskets remain in the exhaust ports**
2. set up the sleeves together with the flanges and springs; make sure they are correctly oriented and that the holes for attaching the springs line up with the loops on the header tubes; tighten the flanges; make sure not to damage the cooling fins (Figure 26, 27)
3. insert the header tubes properly and attach the springs; make sure not to damage the cooling fins (Figure 28, 29)
4. install the water cooler bracket included in the Akrapovic Racing or Evolution kit; make sure not to damage the cooling fins (Figure 30, 31)
5. make sure the header tubes are not touching the engine, oil cooler, other tubes, electrical installations etc.

installing the independent collectors:

1. make sure the collectors are correctly oriented – loops for attaching the springs must line up (Figure 32)
2. slide the collectors onto the header tubes
3. attach the springs (Figure 33)
4. make sure the collectors are not touching the frame and other parts

installing the independent link pipe:

1. slide the link pipe onto the collectors (Figure 34)
2. attach the springs (Figure 35)
3. make sure the link pipe is not touching the frame and other parts

installing the muffler:

1. position the muffler correctly and slide it onto the outlet side of the link pipe (Figure 36)
2. position and attach the springs

3. correctly position the carbon-fiber clamp and slide it onto the muffler - bear in mind the left offset of the carbon-fiber clamp viewed from the rear (**Figure 37**). **WARNING:** open the clamp to slightly wider than the diameter of the outer sleeve of the muffler – do not scrape it along the muffler outer sleeve! (**Figure 38**)
4. tighten the carbon-fiber clamp onto the stock chassis hanging bracket on the frame (**Figure 39**)
5. make sure the muffler is not touching other parts of the motorcycle
6. position of the installed Akrapovic Racing or Evolution system (**Figure 40, 41, 42**)

final installation:

1. tighten the bolts on all of the brackets and clamps to which the exhaust system and the other dismantled parts of the motorcycle are attached
2. clean grease spots:
 - a. muffler – titanium outer sleeve: use a soft cloth sprayed with a multi-purpose spray lubricant (WD-40 or equivalent)
 - b. muffler – carbon-fiber outer sleeve: use a soft dry cloth
 - c. stainless steel link pipe: use a soft cloth sprayed with a contact cleaner, then wipe with a soft dry cloth
 - d. titanium link pipe: use a soft cloth sprayed with a multi-purpose spray lubricant (WD-40 or equivalent)
 - e. evolution model: header tubes - use a soft cloth sprayed with a multi-purpose spray lubricant (WD-40 or equivalent)
 - f. racing model: header tubes - use a soft cloth sprayed with a contact cleaner, then wipe with a soft dry cloth
 Cleaning will prevent spots from burning onto the surface. Do not use aggressive chemical cleaners, because they can damage the sticker.
3. replace all of the dismantled stock parts and cowlings in the reverse order from the order in which they were removed
4. **Check the operation of the brakes and suspension. Make sure all the bolts are sufficiently tightened. In case the exhaust system touches the cowling or other parts repeat the adjustment of the exhaust system or contact your authorized dealer.**

! IT IS NORMAL IF WHITE SMOKE COMES OUT OF THE MUFFLER ON FIRST OPERATION.
! DO NOT STAND BEHIND THE MUFFLER ON FIRST OPERATION.
! DO NOT USE AUTOMOTIVE WHEEL CLEANERS OR ANY CLEANING PRODUCTS WHICH CONTAIN ACIDIC ADDITIVES TO CLEAN AKRAPOVIC EXHAUST SYSTEMS.

MAINTENANCE OF THE AKRAPOVIC EXHAUST SYSTEM

1. Clean the titanium muffler outer sleeve with a multi-purpose spray lubricant (WD-40 or equivalent) and carbon fiber outer sleeve with soft and dry cloth. Do not use aggressive chemical cleaners, because they can damage the sticker. A change in the color of the exhaust system is normal due to the high temperatures.
2. The wearing out of the muffler silencing material depends on the type of the motor and riding style. Contact your dealer/serviceman if visible changes appear on muffler's outer sleeve or the noise level is increased.
3. Periodically make sure all the bolts are sufficiently tight.

Photos:

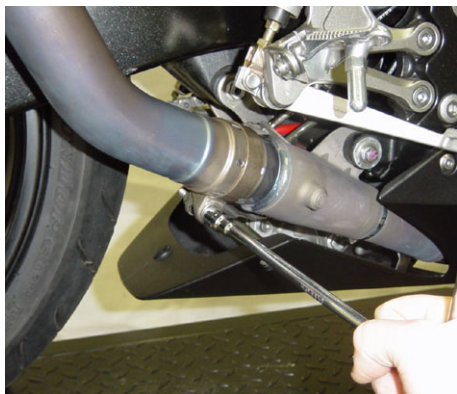

Figure 1

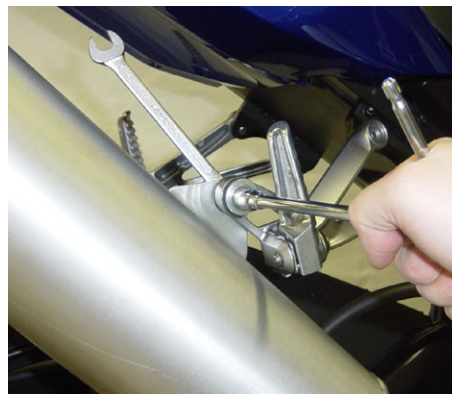

Figure 2



Figure 3



Figure 4



Figure 5

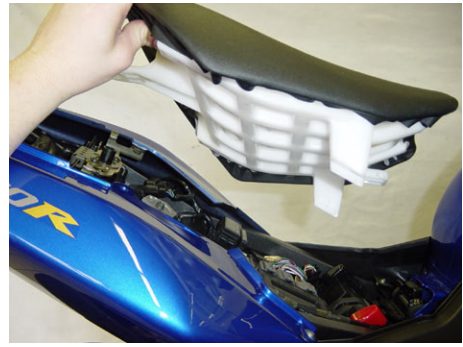

Figure 6

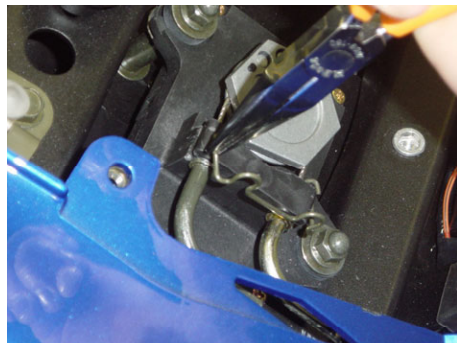

Figure 7

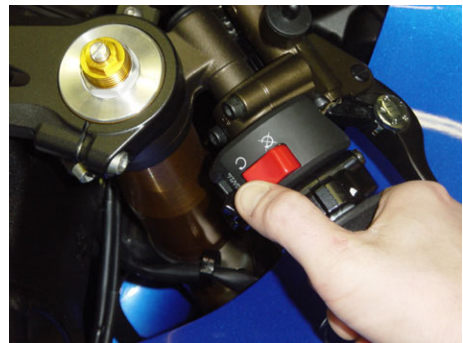

Figure 8



Figure 9

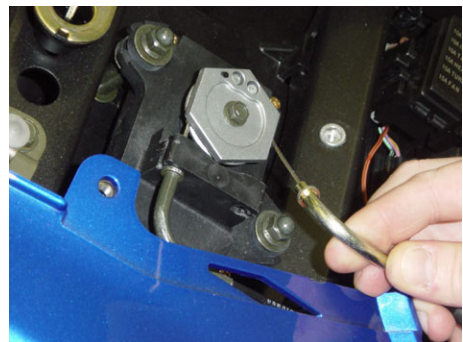

Figure 10



Figure 11

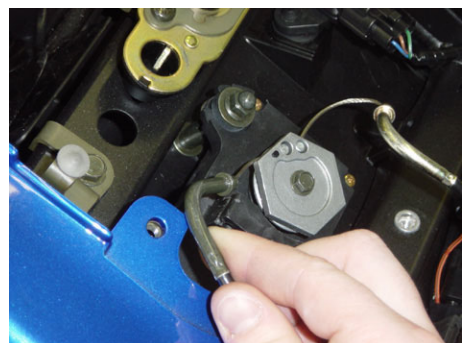

Figure 12

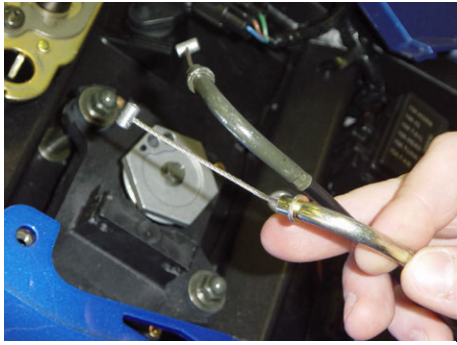

Figure 13

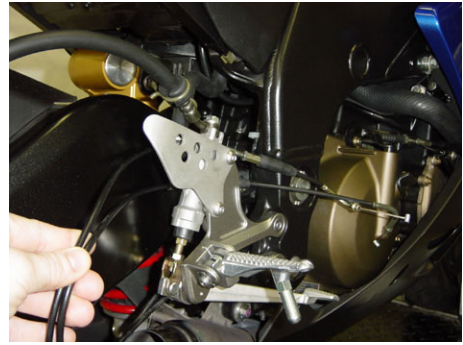

Figure 14

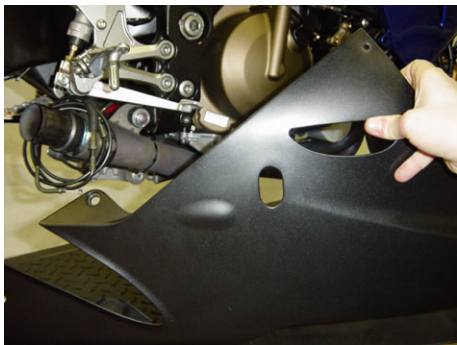

Figure 15



Figure 16



Figure 17



Figure 18

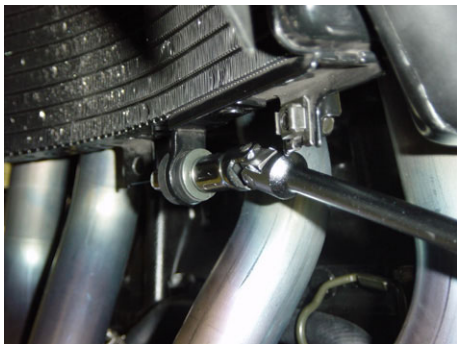

Figure 19



Figure 20



Figure 21

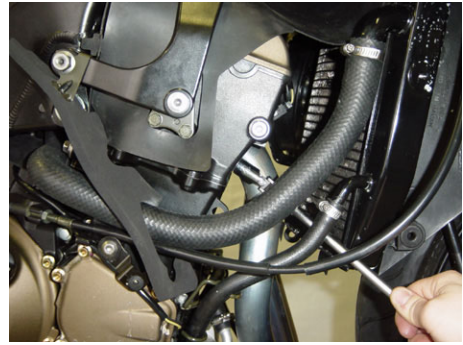

Figure 22

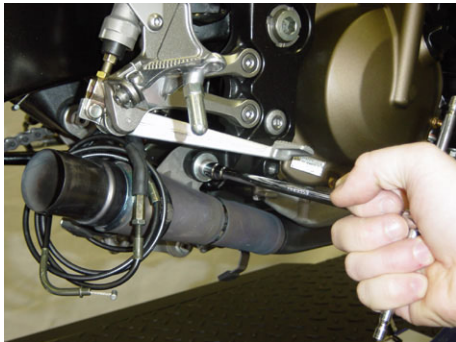

Figure 23

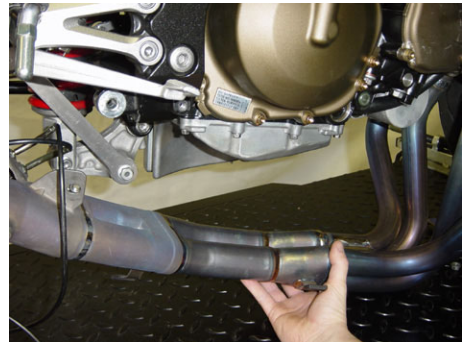

Figure 24

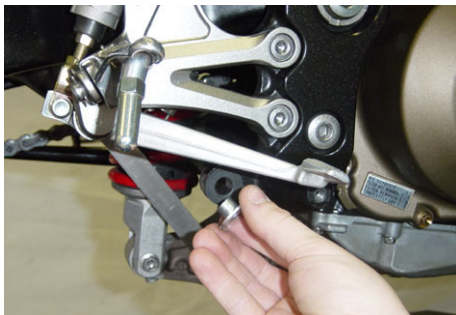

Figure 25

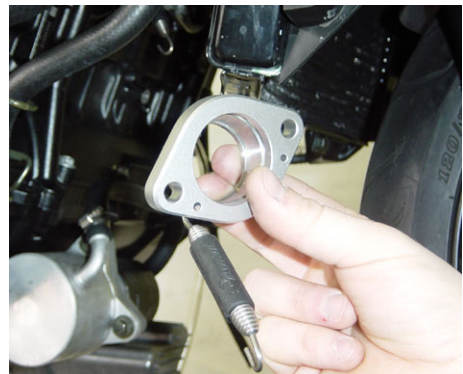

Figure 26



Figure 27

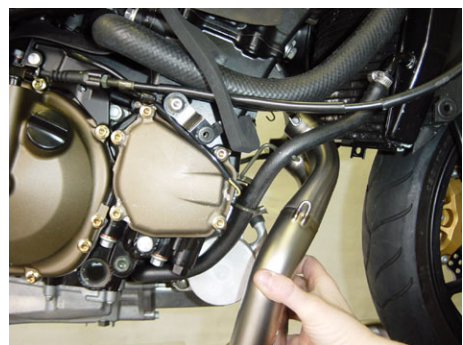

Figure 28



Figure 29

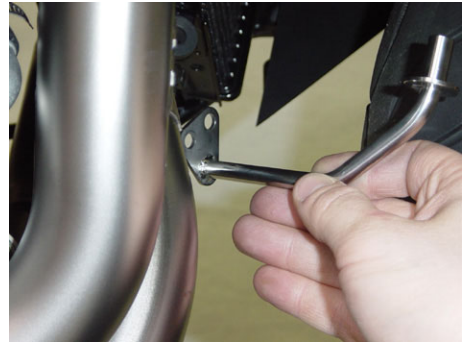

Figure 30



Figure 31

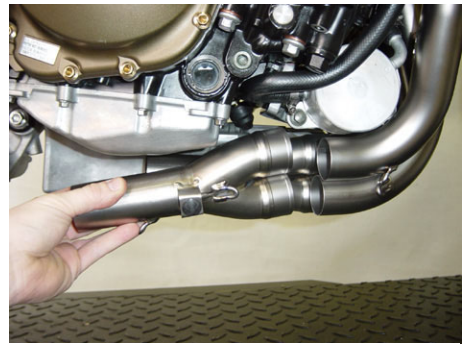

Figure 32

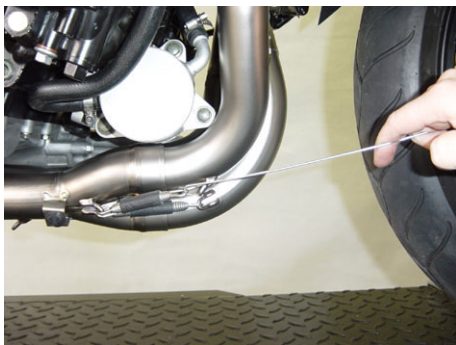

Figure 33



Figure 34



Figure 35

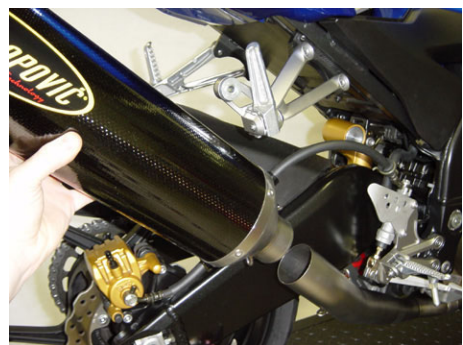

Figure 36



Figure 37



Figure 38

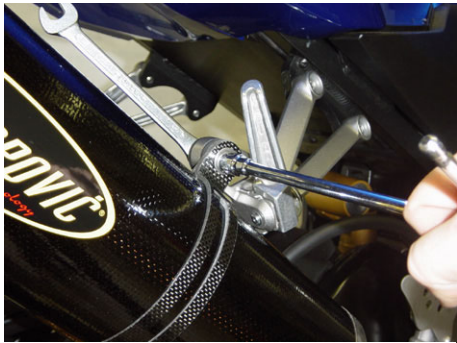

Figure 39



Figure 40



Figure 41



Figure 42

KAWASAKI ZX-10R Complete system/Racing line, model year: 2004-2005

**Product code: 102519 (S-K10R2L-C)
102520 (S-K10R2L-T)**

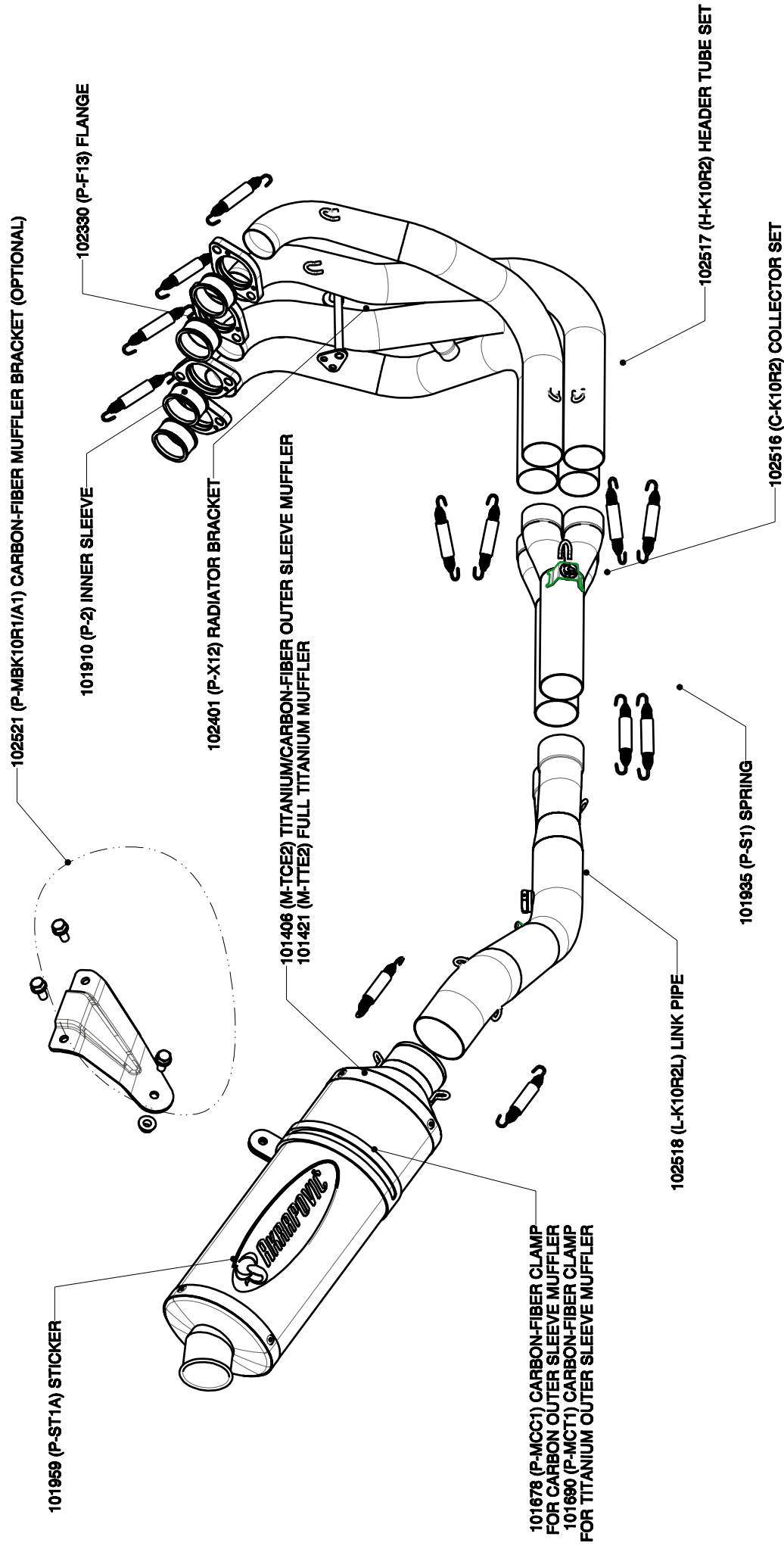

KAWASAKI ZX-10R Complete system/Evolution 1 line, model year: 2004-2005

**Product code: 102515 (S-K10RFT2TL-C)
102497 (S-K10RFT2TL-T)**

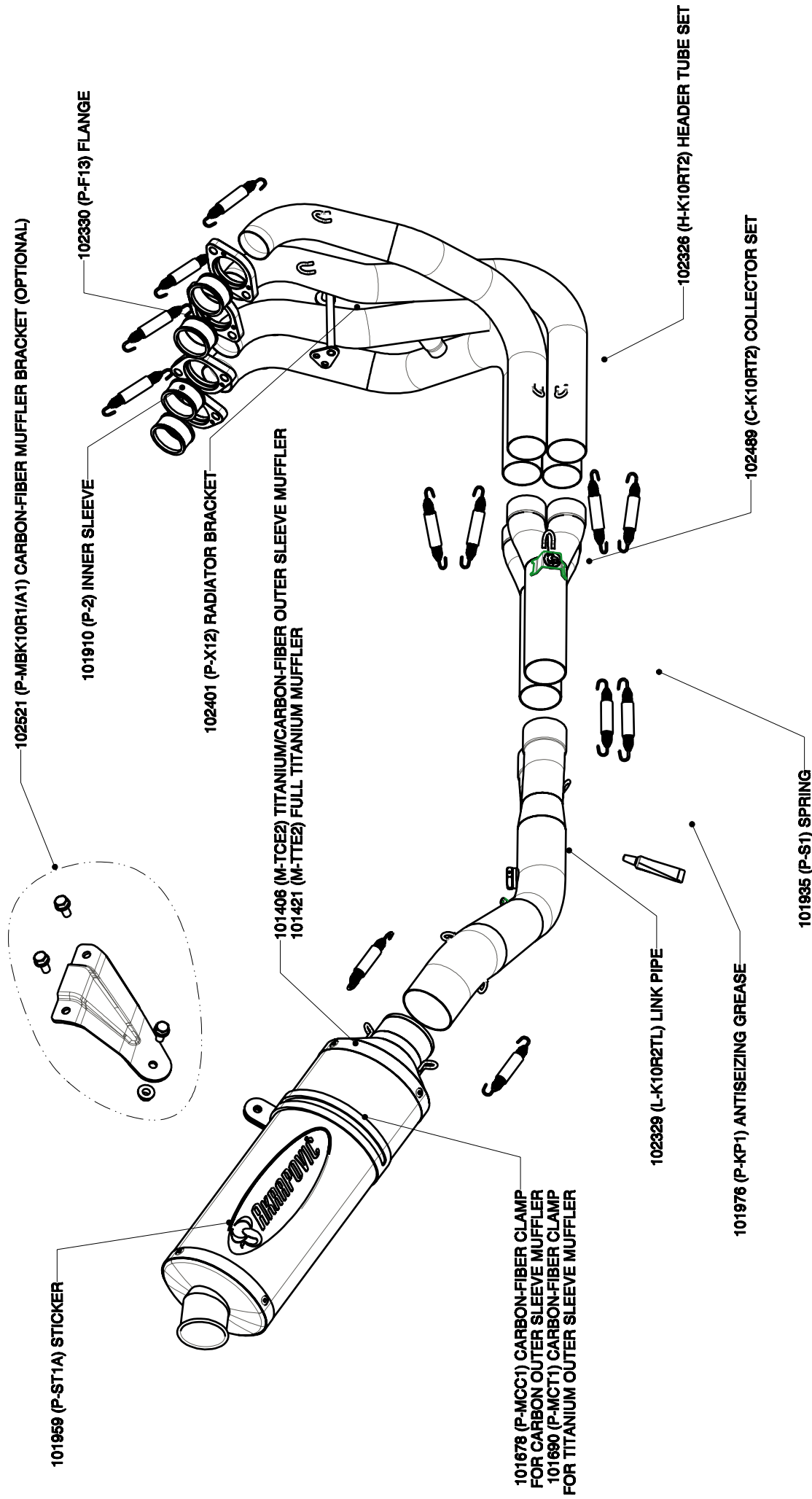

KAWASAKI ZX-10R Complete system/Evolution 2 line, model year: 2004-2005

**Product code: 102524 (S-K10EFT2TL-DC)
102525 (S-K10EFT2TL-DT)**

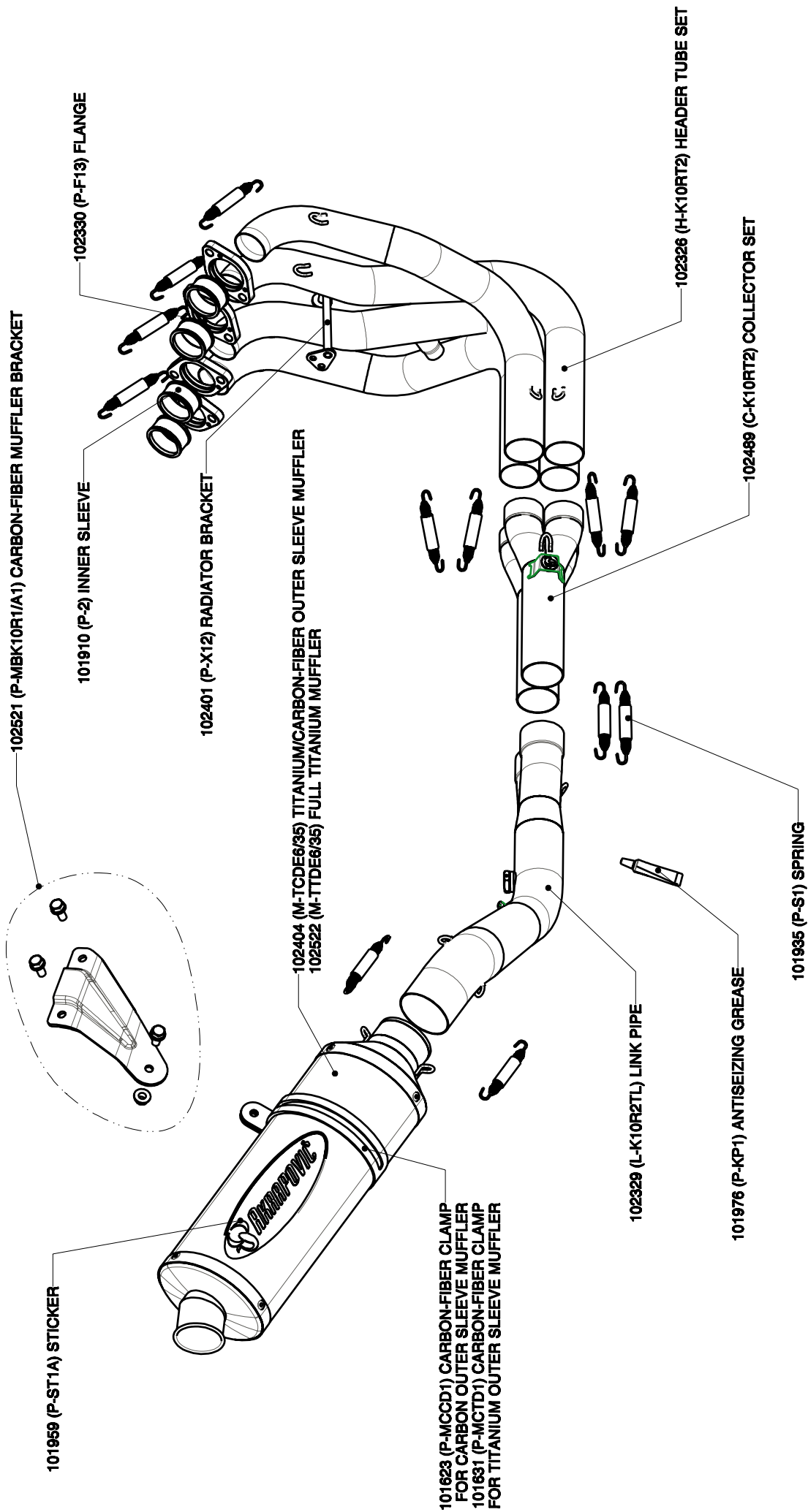

KAWASAKI ZX-10R Complete system/Racing line, model year: 2004-2005/ OPEN

**Product code: 105444 (S-K10R2L-ZT)
105445 (S-K10R2L-ZC)**

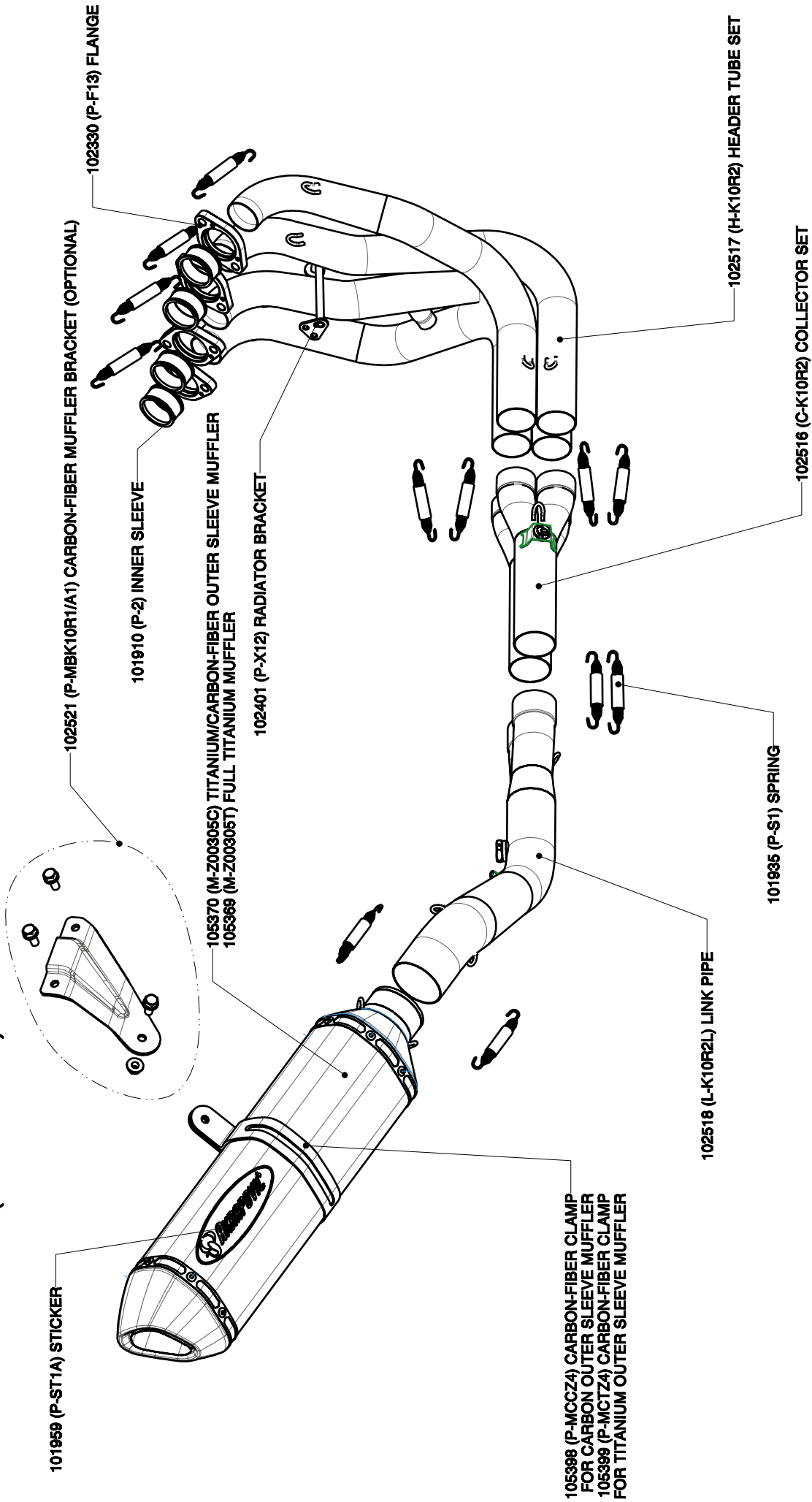

KAWASAKI ZX-10R Complete system/Evolution 1 line, model year: 2004-2005/OPEN

**Product code: 105446 (S-K10RFT2TL-ZT)
105447 (S-K10RFT2TL-ZC)**

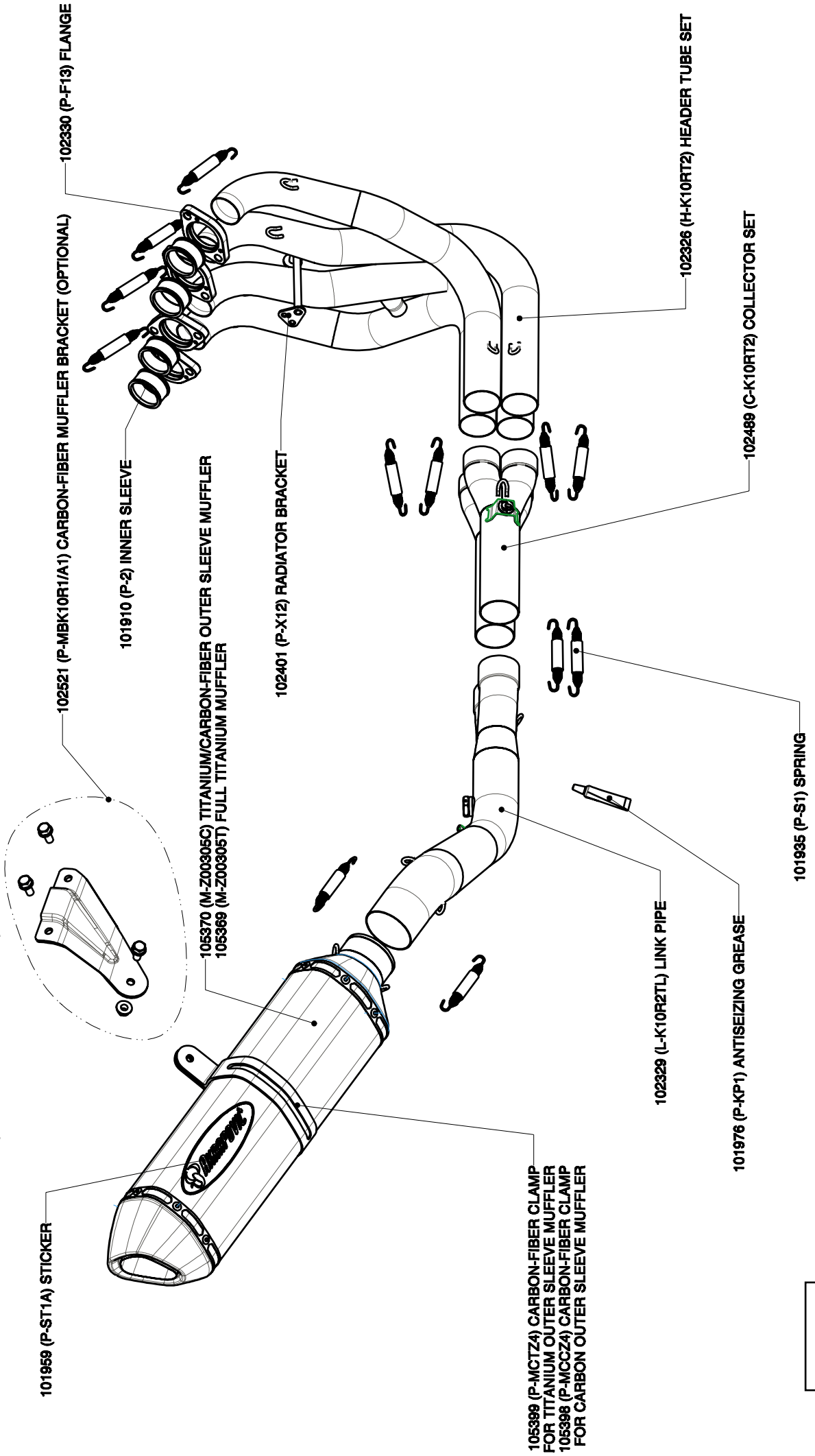

KAWASAKI ZX-10R Complete system/Evolution 2 line, model year: 2004-2005 / OPEN

**Product code: 105448 (S-K10RFT2TL-RT)
105449 (S-K10RFT2TL-RC)**

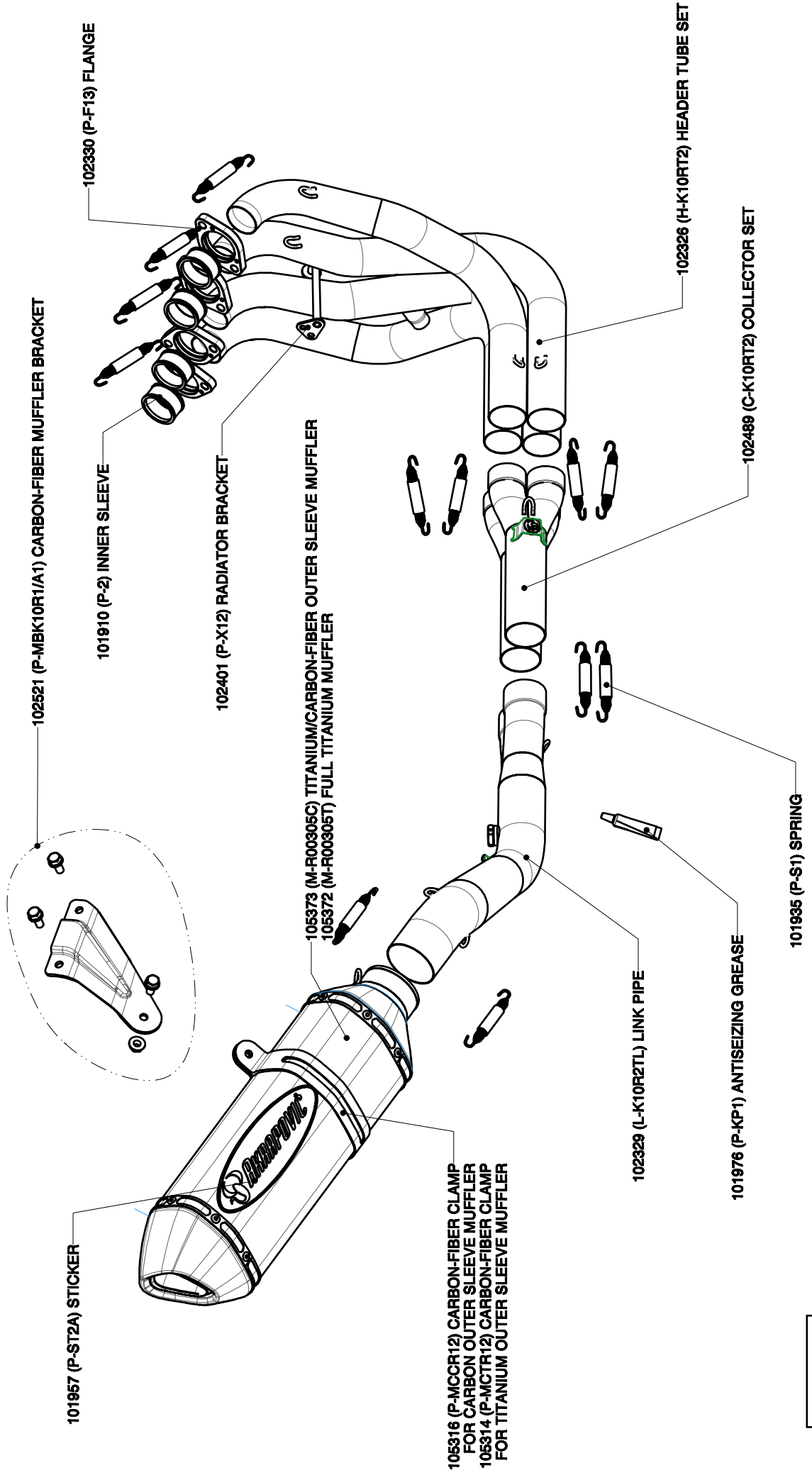

WARNING:

Please note that certain aftermarket exhaust systems may not comply with applicable California laws and regulations, and may therefore be prohibited for use on California highways or roads, or on roads or vehicles otherwise subject to emissions control requirements.

Akrapovič exhaust systems for automobiles and motorcycles mounted downstream of the catalytic converter (also known as “cat-back systems”) are considered “replacement parts” in California by the California Air Resources Board (CARB), and do not require an exemption or executive order from CARB to be sold in California. However, California prohibits the use of any aftermarket exhaust system that modifies, removes or replaces original equipment catalysts, unless CARB has issued an Executive Order as to such part or system.

Further, Akrapovič parts or exhaust systems used or intended for use on “racing vehicles” (i.e. a competition vehicle used exclusively for competition on closed-course circuits) do not require an exemption or Executive Order from CARB to be sold in California. However, such parts are prohibited from use on California public highways or roads, even if occasionally used “off-road.”