



**AKRAPOVIC RACING & EVOLUTION, RACING & EVOLUTION STREET LEGAL
EXHAUST SYSTEM
for the
BMW R 1200 S (2006-2009)**

Congratulations on purchasing an Akrapovic exhaust system. Please read these installation instructions carefully. If you have any trouble installing the system please contact your authorized dealer!

IMPORTANT INFORMATION

Exclusion of Certain Liability

1. The manufacturer, importer or dealer shall not be liable for any incidental damage including personal injury or any other damages caused by improper installation or operation of the Akrapovic exhaust system. When installing the Akrapovic exhaust system be careful that the exhaust system does not touch other parts sensitive to high temperature.
2. Akrapovic makes no representation or warranties with regard to damage caused by the improper installation, use and maintenance of the Akrapovic exhaust system. The warranty is limited to defects recognized by our technical department and to normal use, and excludes items subject to normal wear (gaskets and damping wool). The guarantee is void in case of accident, modification, improper or competition use.
3. Do not attempt to install the Akrapovic exhaust system on a motorcycle for which it was not made or tested by Akrapovic.
4. When the exhaust system gets very hot during operation, be careful not to burn yourself on the exhaust system or parts which are in direct contact with it, even when the motor is not running. Also protect other people, especially children, from the injuries mentioned above.
5. In some cases Akrapovic exhaust system kits contain chemical products (ceramic anti-seizing grease; bolt sealant). Handle with care, do not inhale or swallow. Avoid excessive contact with skin, eyes or mucous membranes. Keep out of reach of children.
6. Technical specifications of Akrapovic exhaust systems and related products subject to change without notice.

Trademarks

The Akrapovic Exhaust System Technology logo is a registered trademark of Akrapovic d.d.

Akrapovic website

Information about Akrapovic exhaust systems and related products is available on the Akrapovic website at:
<http://www.akrapovic.com/>

Copyright

No part of the Akrapovic exhaust system or its documentation may be reproduced or distributed in any form or by any means without the prior written authorization of the Akrapovic company.

© Akrapovic, d.d. All rights reserved.

Symbols

The following symbols are used throughout these installation instructions:



INSTALLATION INSTRUCTIONS

 **BEFORE INSTALLING CHECK SCHEMATIC OF THE EXHAUST SYSTEM!**

 **IF ANY ITEMS IN THE AKRAPOVIC EXHAUST SYSTEM PACKAGE ARE MISSING PLEASE CONTACT YOUR AUTHORIZED DEALER. KEEP THE SCHEMATIC FOR FUTURE REFERENCE.**

 **THESE INSTALLATION INSTRUCTIONS MUST BE READ CAREFULLY IN ORDER TO ENSURE PROPER INSTALLATION AND OPERATION OF THE AKRAPOVIC EXHAUST SYSTEM.**

 **THE EXHAUST SYSTEM CAN BE EXTREMELY HOT. ALLOW THE MOTORCYCLE TO COOL DOWN BEFORE BEGINNING INSTALLATION.**

 **WE ADVISE YOU TO LEAVE INSTALLATION TO A QUALIFIED SERVICEMAN. IMPROPER INSTALLATION MAY RESULT IN A SHORTER LIFETIME OF THE EXHAUST SYSTEM AND/OR DAMAGE TO THE MOTORCYCLE.**

REMOVAL OF STOCK EXHAUST SYSTEM

1. put the motorcycle on a side stand, we recommend a racing stand
2. unlock and remove both seats (**Figure 1, 2, 3**)
3. unscrew the bolts from the muffler metal clamp, (**Figure 4, 5**)
4. unscrew the licence plate bracket and unplug the electrical connector for the light fitting at the rear of the motorcycle (**Figure 6, 7**)
5. undo the springs and remove the muffler (**Figure 8, 9**)
6. unscrew the collector metal clamp – holder (**Figure 10**)
7. correctly and carefully disconnect the lambda sensor connector (**Figure 11, 12, 13, 14**)
8. unscrew the lambda sensors from the header tubes (**Figure 15**)
9. unscrew the header tube flanges and remove the header tubes (**Figure 16, 17**)

INSTALLATION OF THE AKRAPOVIC RACING EXHAUST SYSTEM

installing the header tubes:

1. set up the sleeves together with the flanges and springs; make sure they are correctly oriented and that the holes for attaching the springs line up with the loops on the header tubes; tighten the flanges (**Figure 18, 19-left ; 19a-right**)
2. insert the header tubes properly and attach the springs (**Figure 20, 21, 22**)
3. make sure the header tubes are not touching other parts of the engine
4. reattach the lambda sensors into the header tubes and carefully reconnect the connector (**Figure 23**)

installing the independent collector:

1. correctly position and slide the Akrapovic Y collector onto the header tubes (**Figure 24**)
2. bear in mind the hanging bracket of the collector
3. attach the springs (**Figure 25**)
4. make sure the collector is not touching the frame and other parts

installing the independent link pipe:

1. correctly position and slide the Akrapovic link pipe onto the collector (**Figure 26**)
2. attach the spring at the link pipe – collector joint (**Figure 27**)
3. make sure the link pipe is not touching the frame and other parts

installing the muffler:

1. position the upper stainless steel bracket on the subframe and tighten both bolts (**Figure 28, 29**)
2. correctly position the stainless steel licence plate brackets on the muffler and tighten the bolts - Akrapovic bolt sealant **MUST** be used when tightening the bolts (**Figure 30, 31**)
3. correctly position the double carbon-fiber clamp and slide it onto muffler ; **WARNING:** open the clamp to slightly wider than the diameter of the outer sleeve of the muffler – do not scrape it along the muffler outer sleeve! (**Figure 32**)
4. correctly insert the catalytic converter into the link pipe (**Figure 33**)
5. position the muffler correctly, slide it onto the outlet side of the link pipe and attach the spring – in the case of a titanium link pipe use ceramic anti-seizing grease in the joint (**Figure 34, 35**)
6. tighten the carbon-fiber clamp onto the stainless steel bracket - use the bolts and washers supplied in the Akrapovic kit - Akrapovic bolt sealant **MUST** be used when tightening the bolts (**Figure 36**)
7. tighten the stock licence plate holder onto the Akrapovic stainless steel licence plate brackets - use the bolts and washers supplied in the Akrapovic kit. Make sure the additional parts from the Akrapovic kit are correctly installed. (**Figure 37, 38, 39**)
8. plug the electrical connector for the rear light fitting (**Figure 40**)
9. make sure the muffler is not touching other parts of the motorcycle

final installation:

1. tighten fully all bolts and nuts of the exhaust system
2. replace both seats
3. clean grease spots:
 - a. muffler – titanium outer sleeve and link pipe(welded to muffler): use a soft cloth sprayed with a multi-purpose spray lubricant (WD-40 or equivalent)
 - b. titanium link pipe, collector, header tubes: use a soft cloth sprayed with a multi-purpose spray lubricant (WD-40 or equivalent)
 - c. stainless steel link pipe, collector, header tubes: use a soft cloth sprayed with a contact cleaner, then wipe with a soft dry cloth

Cleaning will prevent spots from burning onto the surface. Do not use aggressive chemical cleaners, because they can damage the sticker.
4. position of the installed Akrapovic Racing system (**Figure 41**)
5. **WARNING: after running engine for 30 minutes, retighten the bolts and nuts of the Akrapovic exhaust system!**

Check the operation of the brakes and suspension. Make sure all the bolts are sufficiently tightened. In case the exhaust system touches the cowling or other parts repeat the adjustment of the exhaust system or contact your authorized dealer.

! IT IS NORMAL IF WHITE SMOKE COMES OUT OF THE MUFFLER ON FIRST OPERATION.

! DO NOT STAND BEHIND THE MUFFLER ON FIRST OPERATION.

! DO NOT USE AUTOMOTIVE WHEEL CLEANERS OR ANY CLEANING PRODUCTS WHICH CONTAIN ACIDIC ADDITIVES TO CLEAN AKRAPOVIC EXHAUST SYSTEMS.

MAINTENANCE OF THE AKRAPOVIC EXHAUST SYSTEM

1. Clean the titanium muffler outer sleeve with a multi-purpose spray lubricant (WD-40 or equivalent). Do not use aggressive chemical cleaners, because they can damage the sticker. A change in the color of the exhaust system is normal due to the high temperatures.
2. The wearing out of the muffler silencing material depends on the type of the motor and riding style. Contact your dealer/serviceman if visible changes appear on muffler's outer sleeve or the noise level is increased.
3. Periodically ensure that all the bolts and springs are sufficiently tight.

Photos:



Figure 1



Figure 2



Figure 3



Figure 4

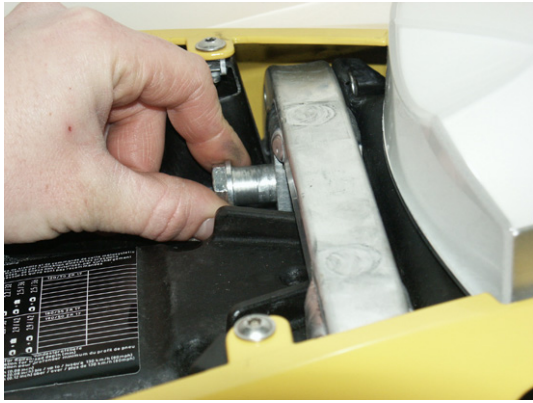

Figure 5



Figure 6

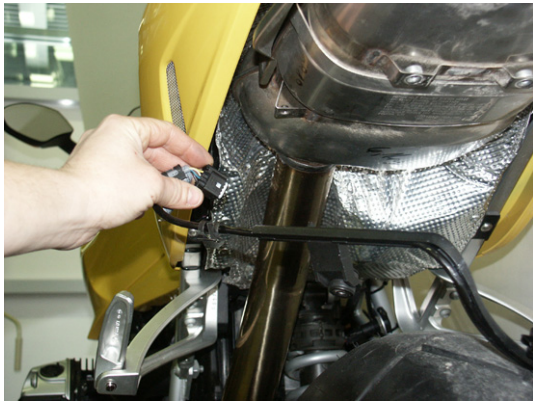

Figure 7



Figure 8



Figure 9

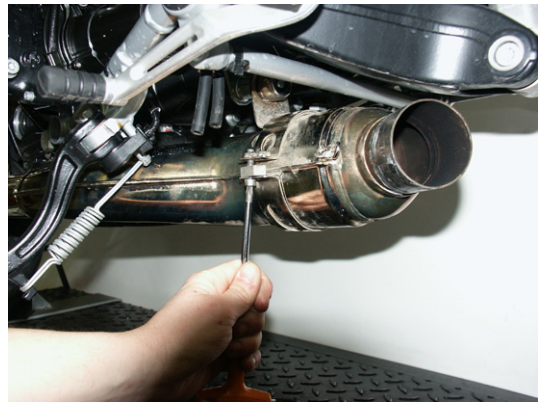

Figure 10



Figure 11



Figure 12



Figure 13



Figure 14



Figure 15



Figure 16

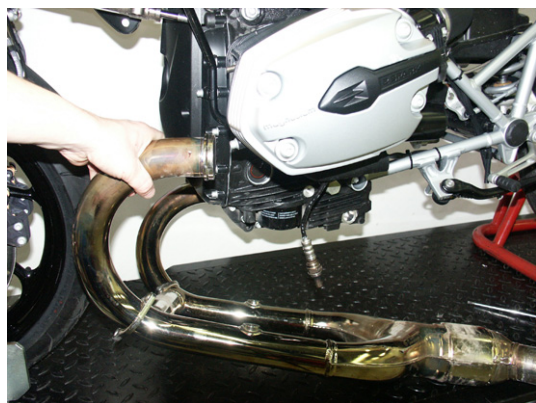

Figure 17



Figure 18



Figure 19



Figure 19a



Figure 20



Figure 21



Figure 22



Figure 23

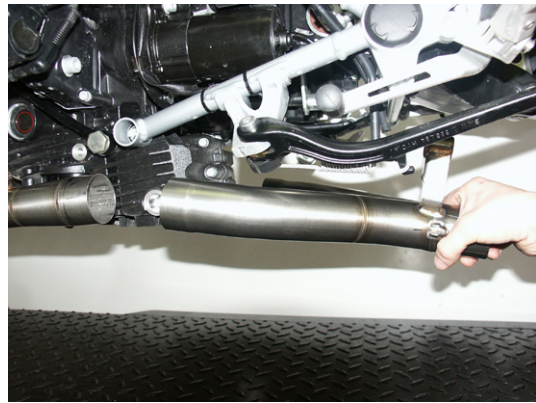

Figure 24



Figure 25



Figure 26

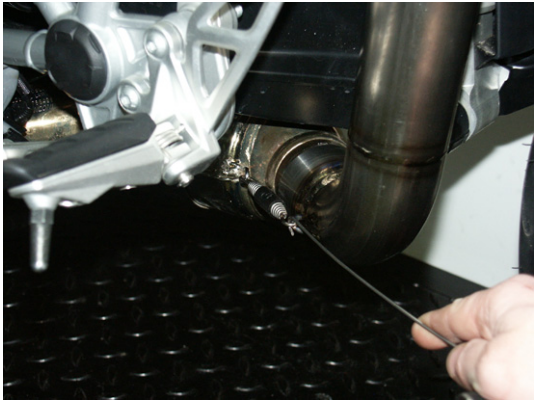

Figure 27



Figure 28



Figure 29



Figure 30



Figure 31



Figure 32



Figure 33



Figure 34



Figure 35



Figure 36



Figure 37



Figure 38



Figure 39



Figure 40



Figure 41

BMW R1200S, Racing line exhaust system, Model year: 2006 - 2009

Product code: 105914 (S-B12R3-UT)

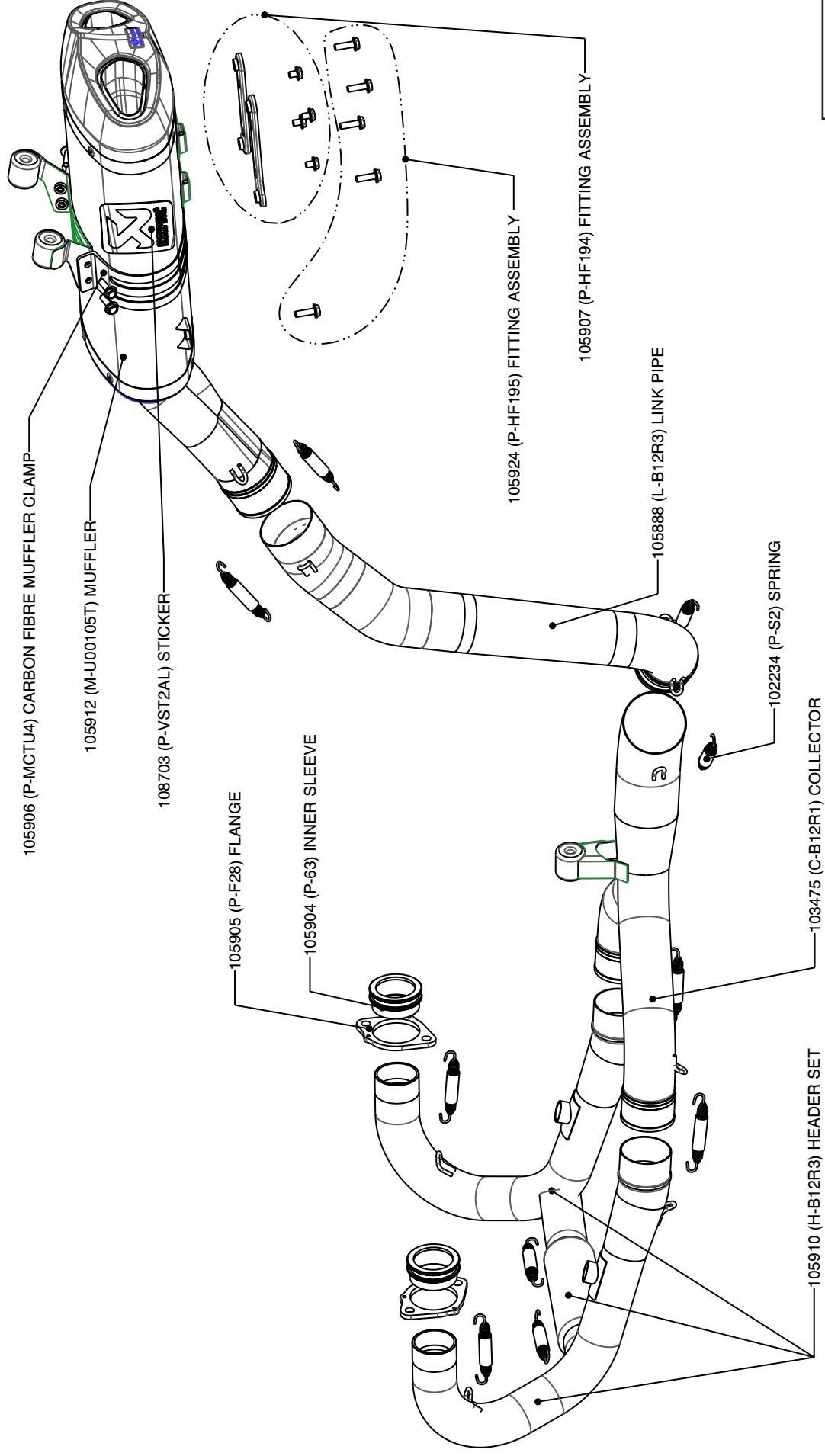

BMW R1200S, Evolution line, Model year: 2006 - 2009

Product code: 105915 (S-B12RFT3T-UT)

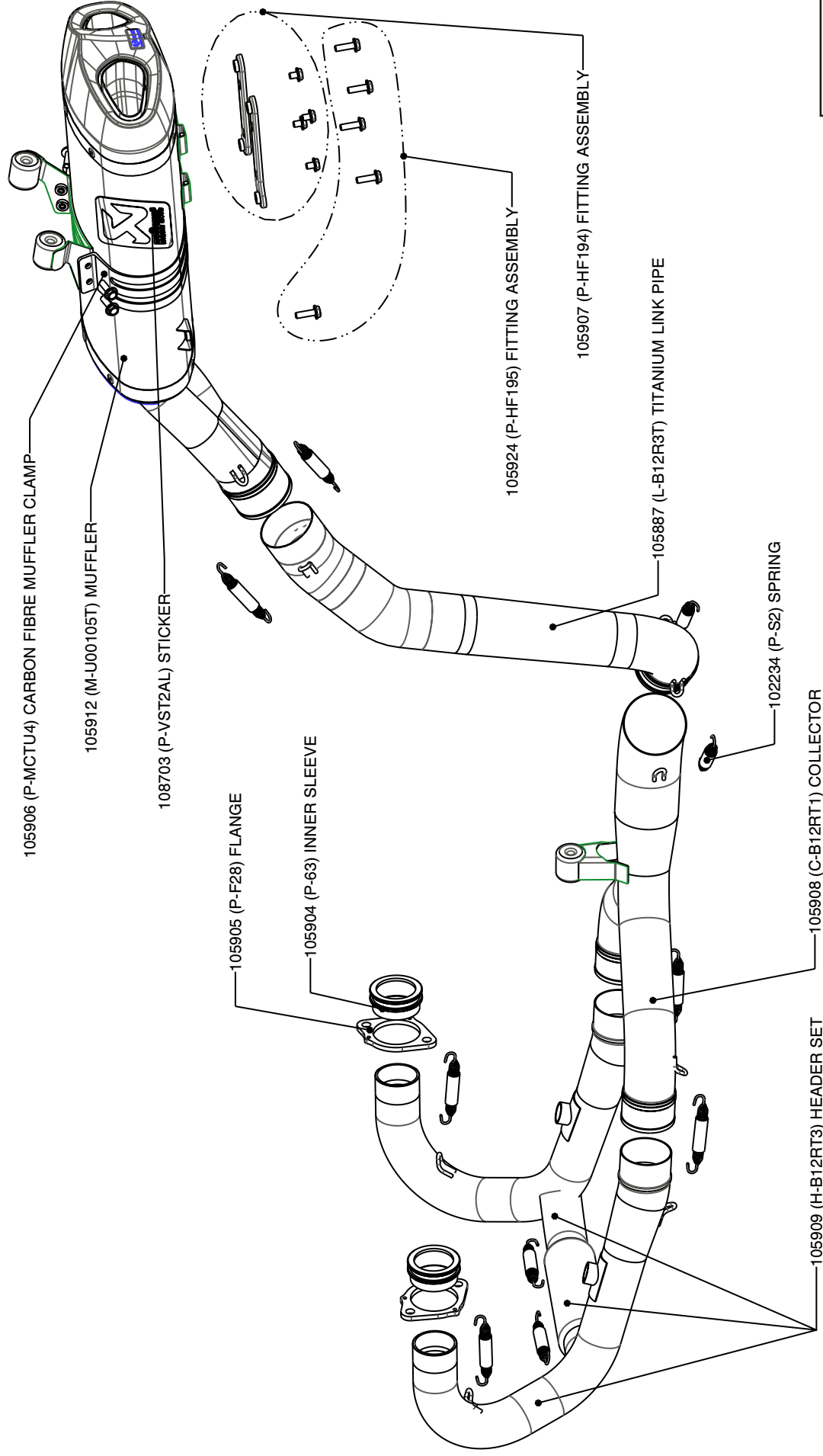

BMW R1200S, Homologated Racing line exhaust system, Model year: 2006-09

Product code: 105919 (S-B12R3C-HUT)

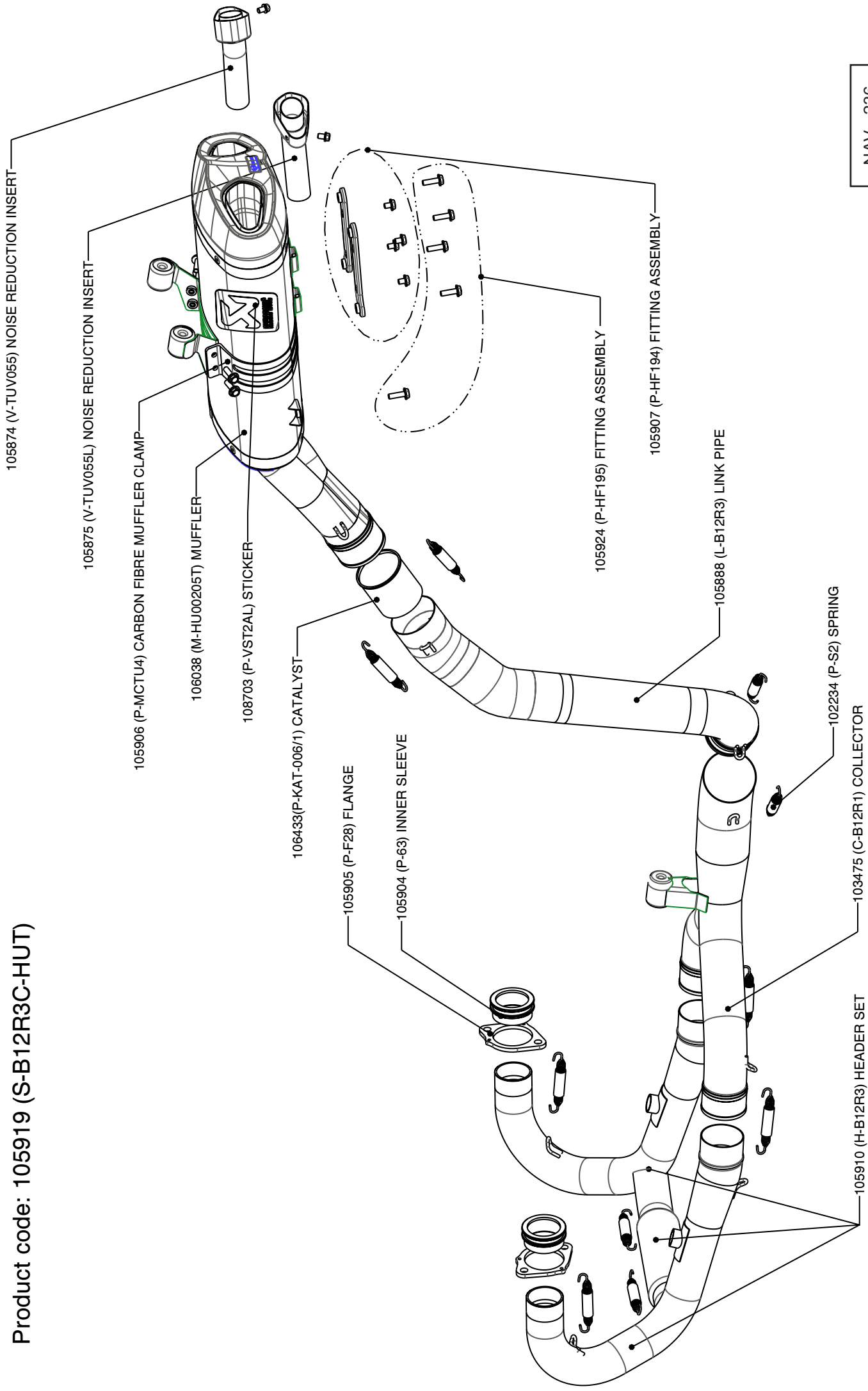

BMW R1200S, Homologated Evolution line exhaust system; Model year: 2006 - 2009

Product code: 105918 (S-B12RFT3TC-HUT)

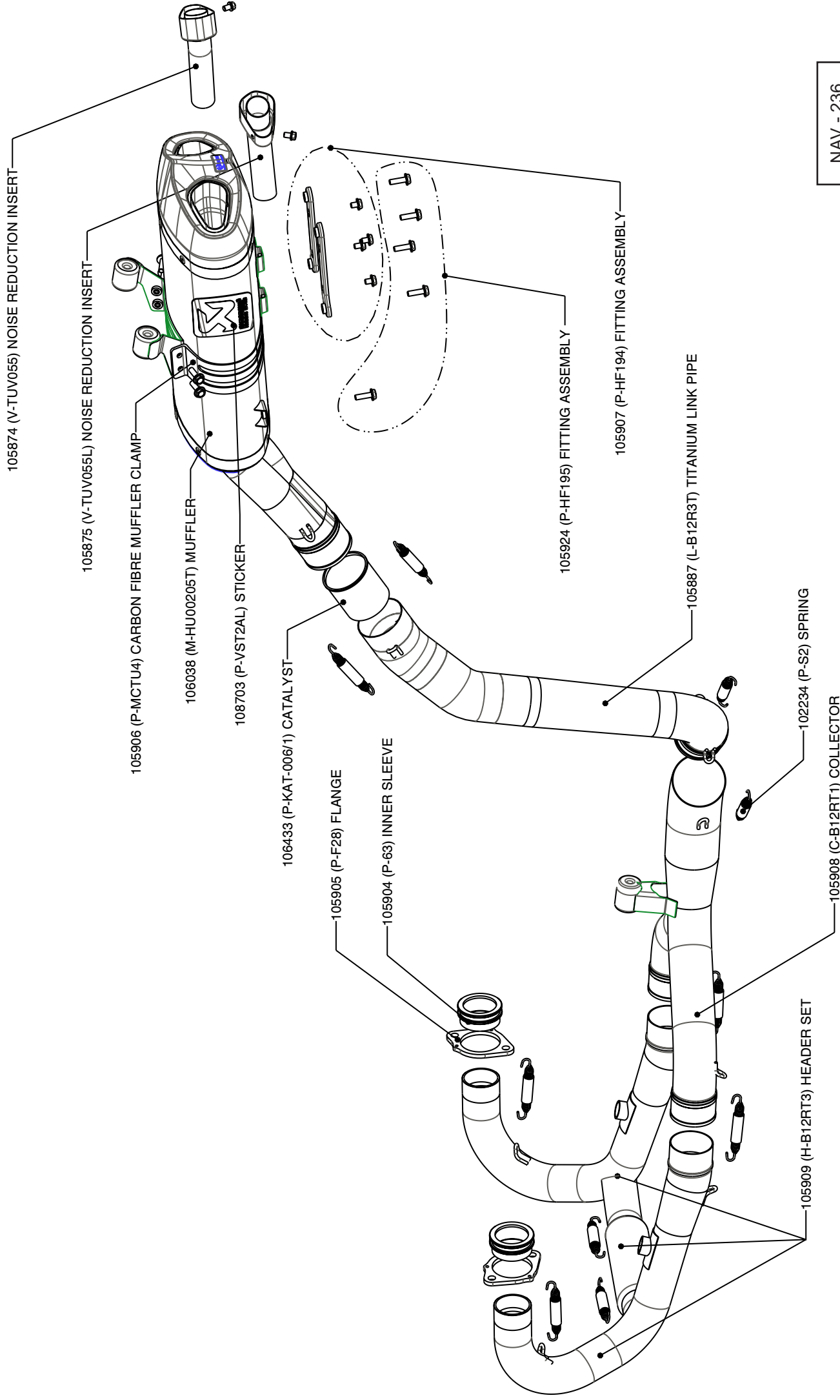

WARNING:

Please note that certain aftermarket exhaust systems may not comply with applicable California laws and regulations, and may therefore be prohibited for use on California highways or roads, or on roads or vehicles otherwise subject to emissions control requirements.

Akrapovič exhaust systems for automobiles and motorcycles mounted downstream of the catalytic converter (also known as “cat-back systems”) are considered “replacement parts” in California by the California Air Resources Board (CARB), and do not require an exemption or executive order from CARB to be sold in California. However, California prohibits the use of any aftermarket exhaust system that modifies, removes or replaces original equipment catalysts, unless CARB has issued an Executive Order as to such part or system.

Further, Akrapovič parts or exhaust systems used or intended for use on “racing vehicles” (i.e. a competition vehicle used exclusively for competition on closed-course circuits) do not require an exemption or Executive Order from CARB to be sold in California. However, such parts are prohibited from use on California public highways or roads, even if occasionally used “off-road.”